



# The Isle of Skye Estate Agency

[www.iosea.co.uk](http://www.iosea.co.uk)

The Isle of Skye Estate Agency

Portree Office: [sales@iosea.co.uk](mailto:sales@iosea.co.uk)

01478 612 683

Kyle Office: [kyle@iosea.co.uk](mailto:kyle@iosea.co.uk)

01599 534 555



## 5 Lower Milovaig, Glendale, Isle of Skye, IV55 8WR.

**Offers Over £140,000**

Detached House

Renovation Project

Double Glazing

Quiet Location

Sea Views

Enclosed Gardens

## Description:

**5 Lower Milovaig is a detached property located in the picturesque township of Milovaig occupying an elevated position boasting sea views across Loch Pooltiel to the headland opposite.**

5 Lower Milovaig is in need of complete renovation and offers prospective purchasers the opportunity to acquire a detached property set within private garden ground boasting sea views. The accommodation within comprises of: Kitchen, lounge, dining room, hallway and bathroom on the ground floor. Stairs lead to the upper floor which, at the moment is one large, open space with Velux windows to the front and rear.

Externally the property is set within fully enclosed garden grounds which are mainly laid to lawn. with a gravel path leading around the front. Parking is available to the front of the property in a small layby.

5 Lower Milovaig provides an exciting renovation project and must be viewed to appreciate the package and development opportunity on offer.

**\*\* Please note the property is not considered suitable for mortgage purposes in its current condition \*\***



## Room sizes

### Ground Floor:

#### Entrance Hall

1.07m x 1.99m (3'06" x 6'06").

#### Lounge

3.29m x 4.08m (10'09" x 13'04").

#### Dining Room

3.40m x 4.06m (11'01" x 13'03").

#### Kitchen

3.47m x 4.39m (11'04" x 14'04").

#### Bathroom

2.92m x 2.04m (9'06" x 6'08").

### First Floor:

#### Attic Room

3.34m x 8.86m (10'11" x 29'00").





# The Isle of Skye Estate Agency

The Isle of Skye Estate Agency

Portree Office: sales@iosea.co.uk

01478 612 683

Kyle Office: kyle@iosea.co.uk

01599 534 555

www.iosea.co.uk

## Services:

Mains water and electricity. Drainage by way of septic tank.

**Council Tax:** Band C

## EPC Rating:

Band G

## Home Report:

Please contact The Isle of Skye Estate Agency.

## Viewings:

Strictly by appointment through The Isle of Skye Estate Agency.

**Entry:** By mutual agreement.

## Directions:

Heading towards Milovaig from Glendale follow the signs for Milovaig/Waterstein/Neist Point. At Carter's Rest take the road up hill signposted for Neist Point. Turn right at the bus stop and continue straight ahead. 5 Lower Milovaig is located on the left hand side just before a white byre with a red roof.

## Location:

Lower Milovaig is a loop road located within the growing community of Glendale situated on the west coast of the island. The village of Glendale has its own village shop and post office and Community Centre. Dunvegan the nearest main village is some 9 miles away and enhanced facilities are available in Portree, the Islands capital, some 30 miles east. Secondary schooling is available in Portree and a school bus service operates.

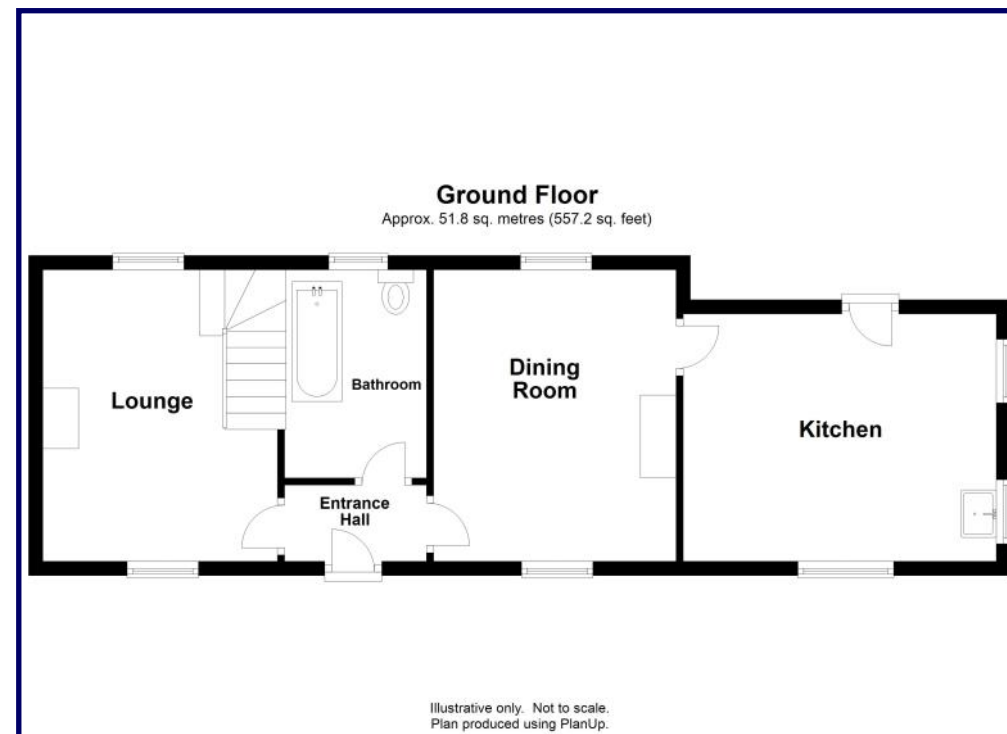

## The Isle of Skye Estate Agency

Portree Office: Bridge Road

Portree  
Isle of Skye  
IV51 9ER  
IV51 9ER

Kyle Office: Main Street  
Kyle of Lochalsh  
Ross-Shire  
IV54 8RD

It is important that if you retain an interest in the acquisition of this property you arrange for your interest to be formally noted to this Agency, otherwise a sale may be concluded on a closing date set without you having been advised.

Every reasonable care has been taken in the drawing up of these particulars for the guidance of interested parties. They are believed to be correct but no guarantee of their accuracy is given and no error or misdescription herein shall annul any sale or be made the subject of compensation by either side. Neither shall these details be deemed to form any part of any contract by either side. Prospective purchasers are advised to take legal advice on the extent and nature of the subjects they propose to acquire.